

PLAN

LEGEND

- Blue asterisk: PRIVATE ACCESS
- Red asterisk: PUBLIC ACCESS
- Blue line with dot: APPROXIMATE LOCATION OF EXISTING SPEED LIMIT SIGN POST
- Red circle with '30': SPEED LIMIT SIGN
- Green/Red hatched box: UPPER HATCH (GREEN) - GEOMETRY IN ACCORDANCE WITH CURRENT DESIGN STANDARDS. LOWER HATCH (RED) - BASED ON CURRENT DESIGN STANDARDS, GEOMETRY WOULD REQUIRE DEPARTURES FROM STANDARDS.
- Green diagonal hatched box: STOPPING SIGHT DISTANCE (SSD) ACHIEVES CURRENT DESIGN STANDARDS
- Red diagonal hatched box: STOPPING SIGHT DISTANCE (SSD) DOES NOT ACHIEVE CURRENT DESIGN STANDARDS

NOTES

CHECK 1 - COMBINED HORIZONTAL AND VERTICAL CHECK IN ACCORDANCE WITH TABLE 3, TD9 OF THE DESIGN MANUAL FOR ROADS AND BRIDGES.

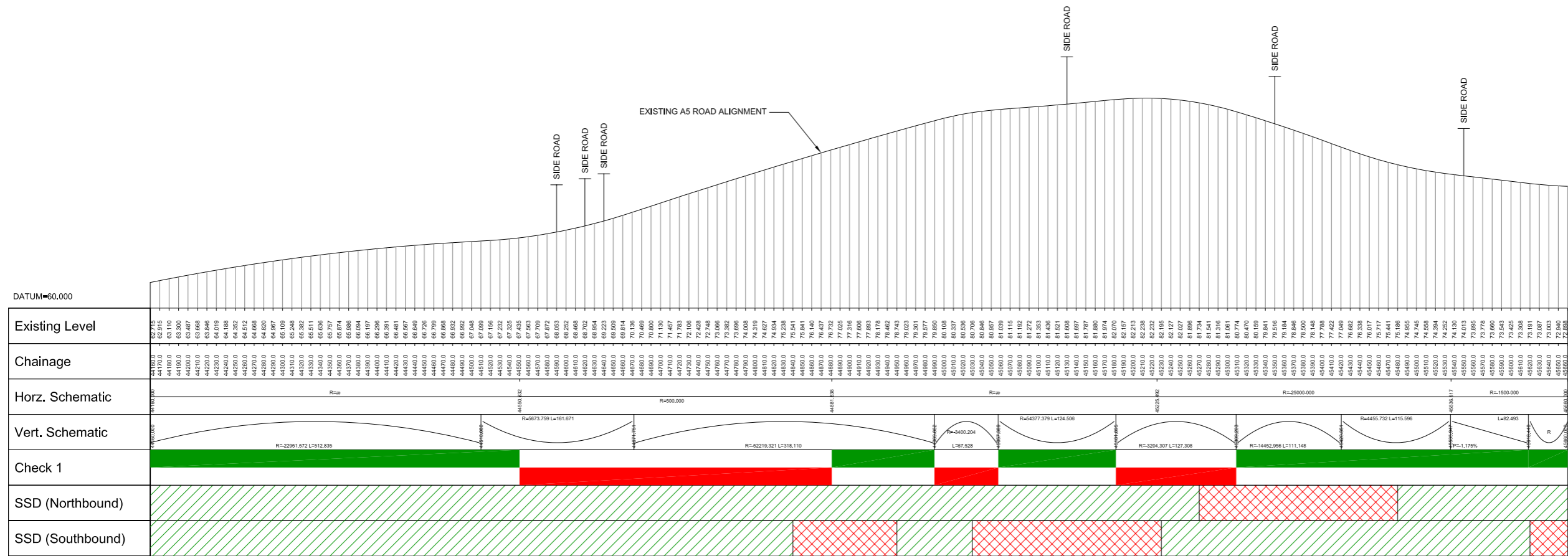

LONGITUDINAL SECTION

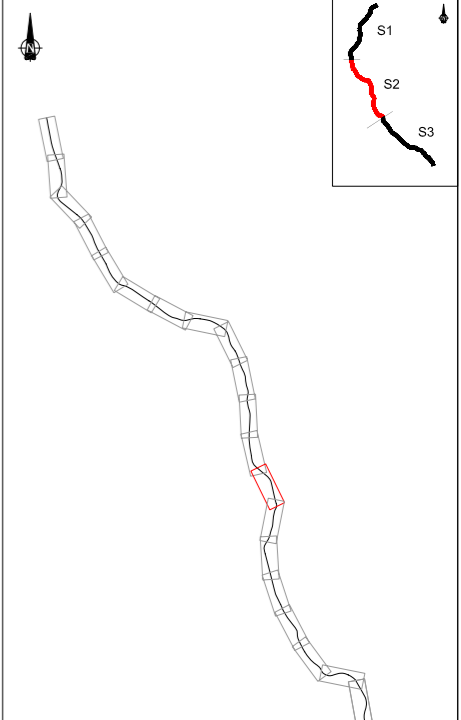

KEY PLAN SECTION 2

VER	DATE	AMENDMENT / VERSION DESCRIPTION	APPROVAL	DESIGNER	CLIENT	OSNI LICENCE	SECTION 2	PROJECT TITLE
B	16/10/2008	INTERNAL REVIEW AND ROADS SERVICE COMMENTS ADDED	KBC	mouchel	ROADS Service	REPRODUCED FROM ORDNANCE SURVEY OF NORTHERN IRELAND'S DATA WITH THE PERMISSION OF THE CONTROLLER OF HER MAJESTY'S STATIONERY OFFICE. © CROWN COPYRIGHT AND DATABASE RIGHTS NIMA ES&LA214, UNAUTHORISED REPRODUCTION INFRINGEMENTS © CROWN COPYRIGHT AND MAY LEAD TO PROSECUTION OR CIVIL PROCEEDINGS	SECTION 2	A5 WESTERN TRANSPORT CORRIDOR
A	08/09/2008	FIRST ISSUE	KBC		A5 WTC		DESIGNED BY VARIOUS	DRAWING TITLE
							DRAWN BY GJI	EXISTING A5 ASSESSMENT
							CHECKED BY KBC	SHEET 31 OF 58
							SCALE AT A1 1:2500	PURPOSE OF ISSUE INFORMATION
								DRAWING No. 796036-0800-D-00031
								VERSION B